

## M6/9 SERIES GAS BROODERS

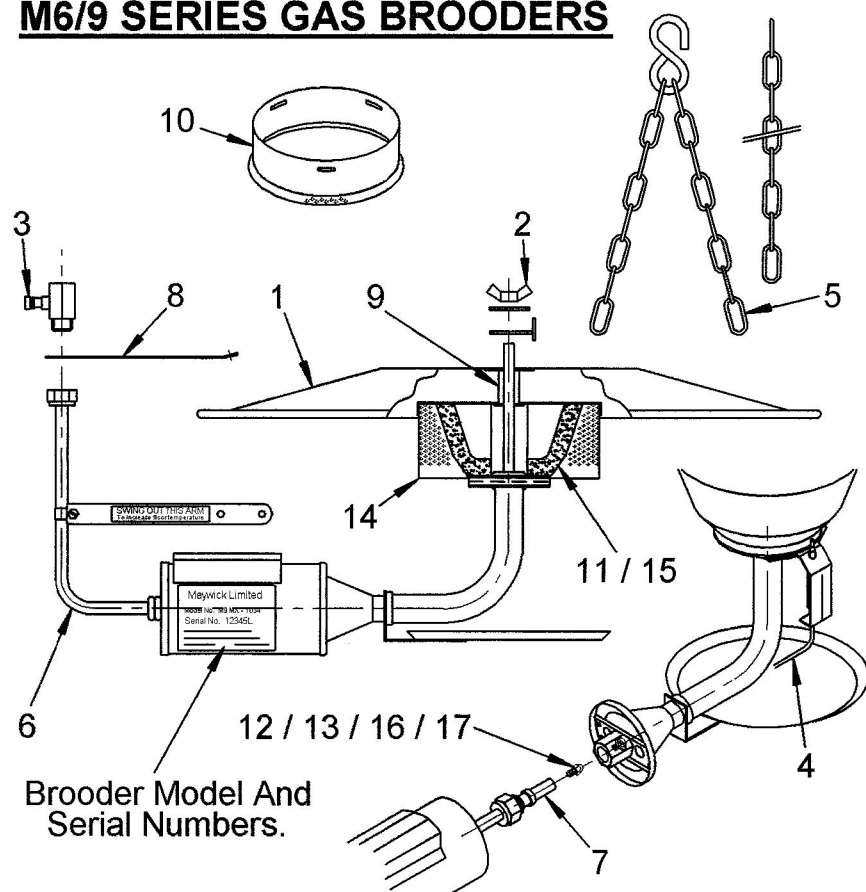

### M6/9 SPARE PARTS

No.	DESCRIPTION.	PART No.
1	Canopy - Aluminised Steel	6500
2	Wing Nut Brass	7001
3	Test Nipple	6094
4	Thermocouple (F/MX Controls)	6095
5	Suspension Kit M6/9	3075
6	Main Feed Assembly M6/9	3201
7	Main Injector	6423
8	Canopy Edge Bracket	4066
9	Top Spacer	6469

### M6 ONLY

10	Replacement Mantle	4203
11	Replacement Cone	6273
12	Main Jet - LPG # 60 'F' Control	6008
13	Main Jet - LPG # 65 'MX' Control	6009

### M9 ONLY

14	Replacement Mantle	3305
15	Replacement Cone	6502
16	Main Jet - LPG # 90 'F' Control	6011
17	Main Jet - LPG # 95 'MX' Control	6061

## M13 SERIES GAS BROODERS

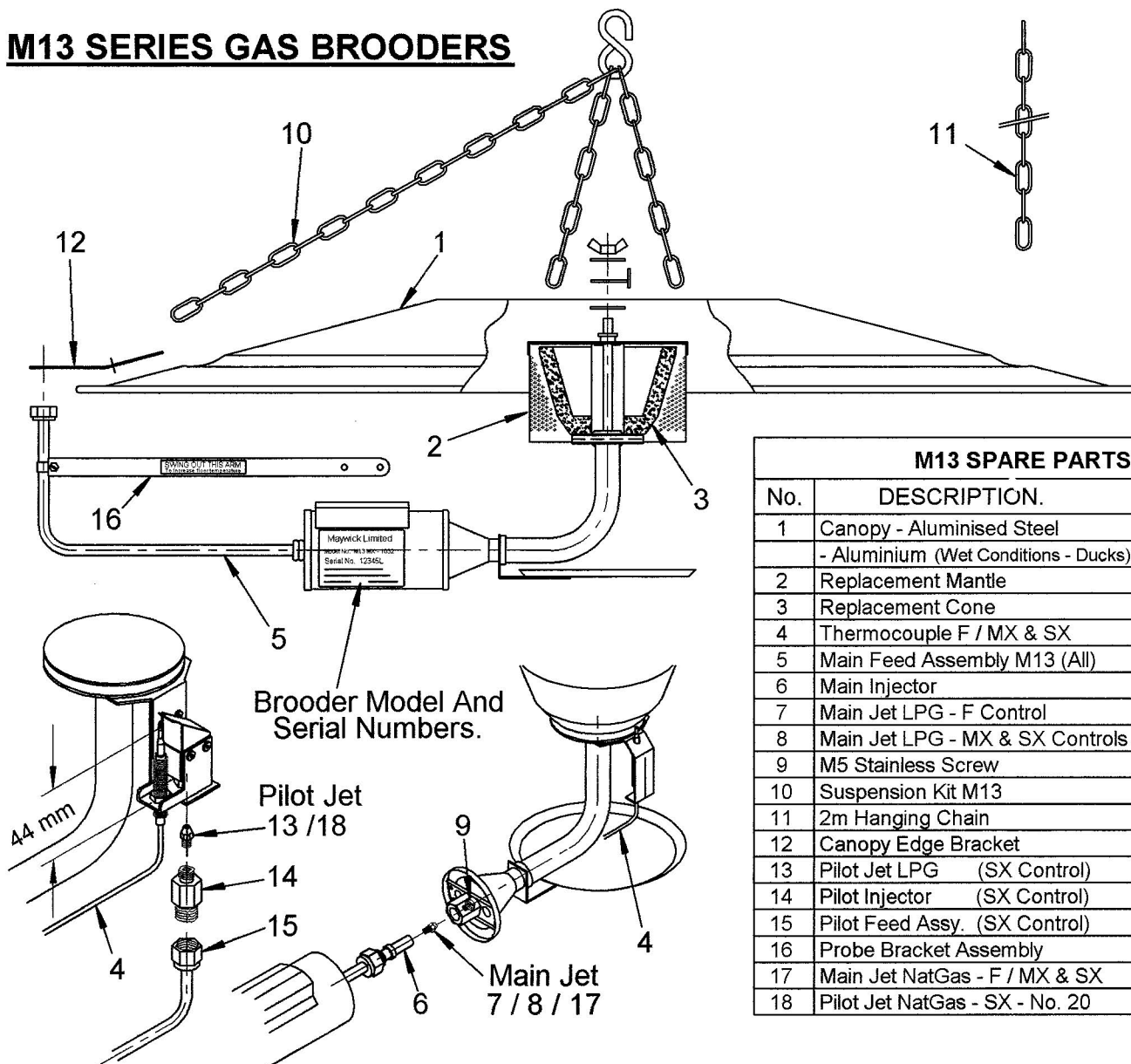

### M13 SPARE PARTS

No.	DESCRIPTION.	PART No.
1	Canopy - Aluminised Steel	6951
	- Aluminium (Wet Conditions - Ducks)	6933
2	Replacement Mantle	3010
3	Replacement Cone	6082
4	Thermocouple F / MX & SX	6095
5	Main Feed Assembly M13 (All)	3223
6	Main Injector	6423
7	Main Jet LPG - F Control	6015
8	Main Jet LPG - MX & SX Controls	6016
9	M5 Stainless Screw	7139
10	Suspension Kit M13	3074
11	2m Hanging Chain	6102
12	Canopy Edge Bracket	6049
13	Pilot Jet LPG (SX Control)	6001
14	Pilot Injector (SX Control)	6112
15	Pilot Feed Assy. (SX Control)	3208
16	Probe Bracket Assembly	3069
17	Main Jet NatGas - F / MX & SX	6025
18	Pilot Jet NatGas - SX - No. 20	6232